

## VERSCHRAUBUNG – Klebemuffe, Rohringengewinde (O-Ring EPDM)

d	G	DN	G1	L	I	I1	Z	E	Art.-Nr.	€
20	1/2"	15	1"	45	19	26	13	43	10.124.001	5,45
25	3/4"	20	1 1/4"	51	22	29	13	53	10.124.002	6,25
32	1"	25	1 1/2"	57	25	32	13	60	10.124.003	8,25
40	1 1/4"	32	2"	67	29	38	15	74	10.124.004	9,70
50	1 1/2"	40	2 1/4"	79	34	45	17	83	10.124.005	13,55
63	2"	50	2 3/4"	97	41	56	21	103	10.124.006	17,35
75	2 1/2"	65	3 1/2"	110	48	62	21	122	10.124.007	46,50
90	3"	80	4"	125	56	69	23	131	10.124.008	54,35
110	4"	100	5"	144	66	78	23	160	10.124.009	62,75

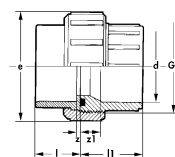

## EINSCHRAUBTEIL – Innengewinde

G	L	Z	F		
1/2"	15,0	11,0	1"	01.142.001	1,85
3/4"	16,3	12,7	1 1/4"	01.142.002	2,15
1"	19,1	12,9	1 1/2"	01.142.003	2,70
1 1/4"	21,4	16,6	2"	01.142.004	3,30
1 1/2"	21,4	23,6	2 1/4"	01.142.005	4,50
2"	25,7	30,3	2 3/4"	01.142.006	6,15
2 1/2"	30,2	32,8	3 1/2"	01.142.007	17,60
3"	59,0	36,7	4"	01.142.008	20,45
4"	69,0	40,7	5"	01.142.009	22,55

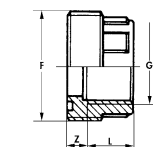

## GEWINDEMUFFE – beidseitig Rohringengewinde

d	DN	c	l	z		
3/8"	10	25	32	6	10.129.001	1,65
1/2"	15	32	36	6	10.129.002	1,75
3/4"	20	36	40	8	10.129.003	1,80
1"	25	45	46	8	10.129.004	2,25
1 1/4"	32	55	52	10	10.129.005	2,90
1 1/2"	40	60	57	13	10.129.006	4,35
2"	50	75	65	14	10.129.007	5,55
2 1/2"	65	93	86	18	10.129.008	15,95
3"	80	110	93	25	10.129.009	19,10

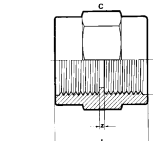

## GEWINDEMUFFE reduziert – beidseitig Rohringengewinde

G <sub>1</sub>	G <sub>2</sub>	L	L <sub>1</sub>	Z	C		
1/2"	3/8"	15,0	11,4	6	24	10.125.020	2,80



## DOPPELNIPPEL – beidseitiges Rohraußengewinde

d	DN	c	l		
3/8"	10	19	31	10.132.001	1,25
1/2"	15	24	40	10.132.002	1,35
3/4"	20	30	44	10.132.003	1,70
1"	25	36	50	10.132.004	1,90
1 1/4"	32	46	56	10.132.005	2,45
1 1/2"	40	50	57	10.132.006	2,80
2"	50	60	67	10.132.007	3,70
2 1/2"	65	78	77	10.132.008	9,85
3"	80	93	81	10.132.009	13,50

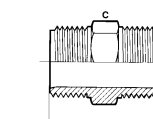

## STOPFEN – Rohraußengewinde

d	DN	c	l		
3/8"	10	22	24	10.133.001	1,25
1/2"	15	24	26	10.133.002	1,35
3/4"	20	30	28	10.133.003	1,70
1"	25	36	32,5	10.133.004	1,90
1 1/4"	32	46	36,5	10.133.005	2,45
1 1/2"	40	50	37,5	10.133.006	2,80
2"	50	60	43	10.133.007	3,70
2 1/2"	65	78	49	10.133.008	10,90
3"	80	93	56	10.133.009	13,95

