

PVC-Fittings

MUFFE - Klebemuffe

| d | DN | l | z | Art.-Nr. | € |
|------|-----|-----|----|------------|--------|
| 12 | 8 | 27 | 3 | 10.101.001 | 1,00 |
| 16 | 10 | 31 | 3 | 10.101.002 | 1,10 |
| 20 | 15 | 35 | 3 | 10.101.003 | 1,10 |
| 25 | 20 | 41 | 3 | 10.101.004 | 1,15 |
| 32 | 25 | 47 | 3 | 10.101.005 | 1,25 |
| 40 | 32 | 55 | 3 | 10.101.006 | 2,00 |
| 50 | 40 | 65 | 3 | 10.101.007 | 2,60 |
| 63 | 50 | 79 | 3 | 10.101.008 | 3,70 |
| 75 | 65 | 92 | 4 | 10.101.009 | 7,85 |
| 90 | 80 | 107 | 5 | 10.101.010 | 13,15 |
| 110 | 100 | 128 | 6 | 10.101.011 | 18,20 |
| 140 | 125 | 160 | 8 | 10.101.012 | 39,60 |
| 160 | 150 | 180 | 8 | 10.101.013 | 47,65 |
| *225 | 200 | 250 | 10 | 10.101.014 | 175,75 |
| *280 | 250 | 300 | 10 | 10.101.015 | 399,40 |
| *315 | 300 | 341 | 11 | 10.101.016 | 436,45 |

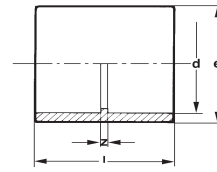

WINKEL 90° - Klebemuffe

| | | | | | |
|------|-----|------|------|------------|--------|
| 12 | 8 | 20 | 8 | 10.109.001 | 1,15 |
| 16 | 10 | 23 | 9 | 10.109.002 | 1,15 |
| 20 | 15 | 27 | 11 | 10.109.003 | 1,35 |
| 25 | 20 | 33 | 14 | 10.109.004 | 1,60 |
| 32 | 25 | 39 | 17 | 10.109.005 | 2,00 |
| 40 | 32 | 47 | 21 | 10.109.006 | 3,25 |
| 50 | 40 | 57,5 | 26,5 | 10.109.007 | 4,40 |
| 63 | 50 | 71 | 33 | 10.109.008 | 6,35 |
| 75 | 65 | 84 | 40 | 10.109.009 | 14,00 |
| 90 | 80 | 98 | 47 | 10.109.010 | 18,20 |
| 110 | 100 | 118 | 57 | 10.109.011 | 26,85 |
| 140 | 125 | 150 | 74 | 10.109.012 | 68,75 |
| 160 | 150 | 168 | 82 | 10.109.013 | 104,60 |
| *225 | 200 | 235 | 116 | 10.109.014 | 337,90 |
| *280 | 250 | 295 | 149 | 10.109.015 | 837,75 |
| *315 | 300 | 322 | 158 | 10.109.016 | 949,75 |

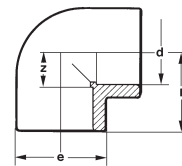

WINKEL 90° - Klebemuffe, Außengewinde

| | | |
|------------------|------------|------|
| 1" AG - 25 Klebe | 11.680.266 | 3,20 |
| 2" AG - 50 Klebe | 11.680.265 | 4,70 |



WINKEL 90° - Klebemuffe - Klebestutzen

| | | |
|------|------------|------|
| d 50 | 11.680.267 | 4,50 |
| d 63 | 11.680.268 | 7,40 |



WINKEL 45° - Klebemuffe - Klebestutzen

| | | |
|------|------------|------|
| d 50 | 11.680.275 | 4,65 |
| d 63 | 11.680.276 | 7,40 |



WINKEL 45° - Klebemuffe

| | | | | | |
|------|-----|-----|----|------------|--------|
| 12 | 8 | 16 | 4 | 10.110.001 | 2,20 |
| 16 | 10 | 19 | 5 | 10.110.002 | 2,20 |
| 20 | 15 | 21 | 5 | 10.110.003 | 2,20 |
| 25 | 20 | 25 | 6 | 10.110.004 | 2,40 |
| 32 | 25 | 30 | 8 | 10.110.005 | 3,20 |
| 40 | 32 | 36 | 10 | 10.110.006 | 4,15 |
| 50 | 40 | 43 | 12 | 10.110.007 | 4,95 |
| 63 | 50 | 53 | 15 | 10.110.008 | 7,70 |
| 75 | 65 | 62 | 18 | 10.110.009 | 12,90 |
| 90 | 80 | 72 | 21 | 10.110.010 | 17,25 |
| 110 | 100 | 86 | 25 | 10.110.011 | 37,45 |
| 140 | 125 | 108 | 32 | 10.110.012 | 68,85 |
| 160 | 150 | 122 | 36 | 10.110.013 | 81,20 |
| *225 | 200 | 171 | 52 | 10.110.014 | 251,60 |
| *280 | 250 | 208 | 62 | 10.110.015 | 653,20 |
| *315 | 300 | 232 | 68 | 10.110.016 | 870,95 |

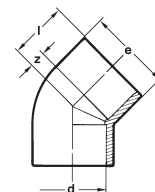

* Lieferzeit auf Anfrage!