

## VERSCHRAUBUNG – Klebemuffe, Rohringengewinde (O-Ring EPDM)

d	G	DN	G1	L	I	I1	Z	E	Art.-Nr.	€
20	1/2"	15	1"	45	19	26	13	43	10.124.001	6,85
25	3/4"	20	1 1/4"	51	22	29	13	53	10.124.002	7,85
32	1"	25	1 1/2"	57	25	32	13	60	10.124.003	10,35
40	1 1/4"	32	2"	67	29	38	15	74	10.124.004	12,15
50	1 1/2"	40	2 1/4"	79	34	45	17	83	10.124.005	16,95
63	2"	50	2 3/4"	97	41	56	21	103	10.124.006	21,70
75	2 1/2"	65	3 1/2"	110	48	62	21	122	10.124.007	58,15
90	3"	80	4"	125	56	69	23	131	10.124.008	67,95
110	4"	100	5"	144	66	78	23	160	10.124.009	78,45

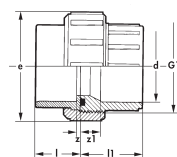

## GEWINDEMUFFE – beidseitig Rohringengewinde

d	DN	c	I	z	Art.-Nr.	€
3/8"	10	25	32	6	10.129.001	2,10
1/2"	15	32	36	6	10.129.002	2,20
3/4"	20	36	40	8	10.129.003	2,25
1"	25	45	46	8	10.129.004	2,85
1 1/4"	32	55	52	10	10.129.005	3,65
1 1/2"	40	60	57	13	10.129.006	5,45
2"	50	75	65	14	10.129.007	6,95
2 1/2"	65	93	86	18	10.129.008	19,95
3"	80	110	93	25	10.129.009	23,90

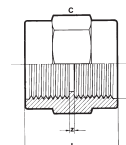

## GEWINDEMUFFE reduziert – beidseitig Rohringengewinde

G <sub>1</sub>	G <sub>2</sub>	L	L <sub>1</sub>	Z	C	Art.-Nr.	€
1/2"	3/8"	15,0	11,4	6	24	10.125.020	3,50



## DOPPELNIPPEL – beidseitiges Rohraußengewinde

d	DN	c	I	Art.-Nr.	€
3/8"	10	19	31	10.132.001	1,60
1/2"	15	24	40	10.132.002	1,70
3/4"	20	30	44	10.132.003	2,15
1"	25	36	50	10.132.004	2,40
1 1/4"	32	46	56	10.132.005	3,10
1 1/2"	40	50	57	10.132.006	3,50
2"	50	60	67	10.132.007	4,65
2 1/2"	65	78	77	10.132.008	12,35
3"	80	93	81	10.132.009	16,90

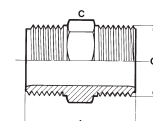

## STOPFEN – Rohraußengewinde

d	DN	c	I	Art.-Nr.	€
3/8"	10	22	24	10.133.001	1,60
1/2"	15	24	26	10.133.002	1,70
3/4"	20	30	28	10.133.003	2,15
1"	25	36	32,5	10.133.004	2,40
1 1/4"	32	46	36,5	10.133.005	3,10
1 1/2"	40	50	37,5	10.133.006	3,50
2"	50	60	43	10.133.007	4,65
2 1/2"	65	78	49	10.133.008	13,65
3"	80	93	56	10.133.009	17,45

